

Pyrotx I Fire Seals for EJs

Pyrotx I: High-movement firesealing system. Pyl is very simply installed by insertion into masonry floors and walls. The range of sizes are suitable for gaps 20mm to 150mm. The system is tested/certified to AS 1530.4 and BS476. Pyl has seismic capability, and can be used in conjunction with most Unison coverplate and waterseal systems.

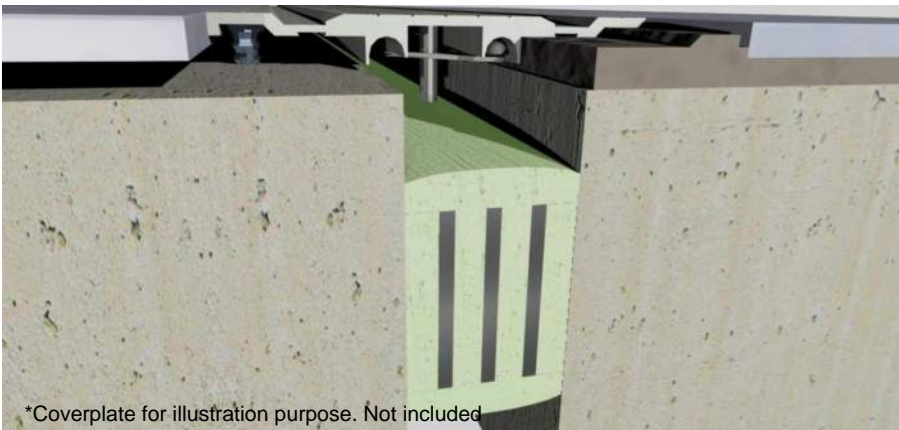

Previous Model No: UFI

Indoor Outdoor Multi-directional

Performance

- Expansion Joint Fireseal
- High fire resistance
- High movement capacity
- Floor application
- Wall system seals both sides
- Compatible with coverplates & water seals
- Structural/Thermal/Seismic movements
- 2/4 hours fire rating
- Tested and comply with: AS 1530.4, AS 4072.1, BS 476.20

Standard Length 1.2m

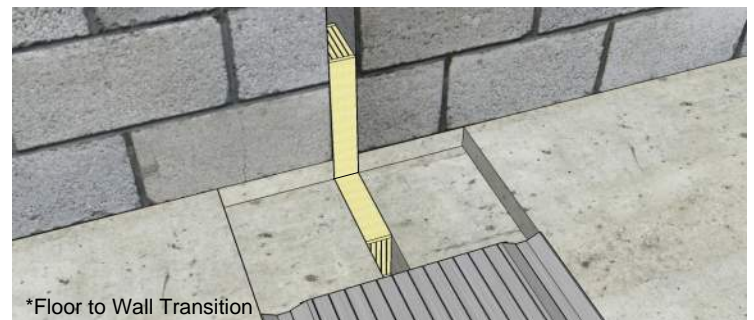
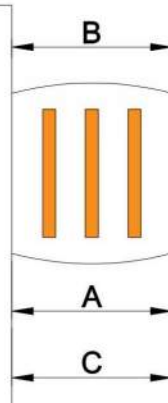

Product	A: Seal		B: Gap				C: Min. Installation Width
	Width	Depth	Min.	Mid.	Max.	Mvmt.	
Py25I - 2hrs	32	35	10	20	25	15	14
Py35I - 2hrs	38	50	15	25	35	20	18
Py35I - 4hrs	38	75	15	25	35	20	18
Py50I - 2hrs	64	66	18	34	50	32	25
Py50I - 4hrs	64	91	18	34	50	32	25
Py75I - 2hrs	100	91	29	52	75	46	40
Py75I - 4hrs	100	91	29	52	75	46	40
Py100I - 2hrs	126	116	34	71	100	66	50
Py100I - 4hrs	126	116	34	71	100	66	50
Py110I - 2hrs	121	108	38	74	110	72	57
Py120I - 3hrs	134	118	42	81	120	78	64
Py130I - 3hrs	147	133	46	88	130	84	71
Py140I - 3hrs	151	133	50	95	140	90	78
Py150I - 3hrs	159	133	54	112	150	96	85

Disclaimer: Open-cell foam suspension material in Pyl can be subject to "Compression-set". It is therefore essential that Pyl Fireseals are bonded to substrates or other means, such as stepped rebating or mechanical fixings are employed to keep butt-joints aligned and stop Pyl from slipping out. All design rights reserved. Design and specifications are subject to change without notice. The manufacturer does not accept liability where the material on these pages is misconceived, exploited, or lacks conformity. The intention of this information is to provide a reasonable description of products, procedures and capabilities. Rev.17